

USER'S MANUAL

Part list & Accessory

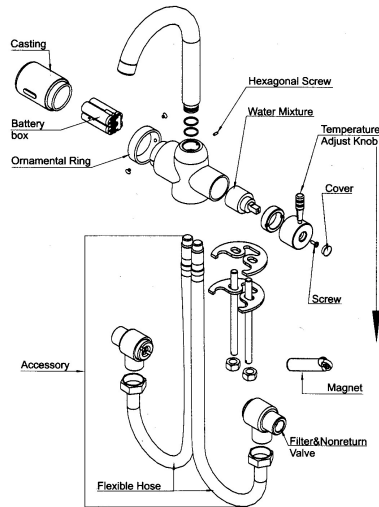

Standard size

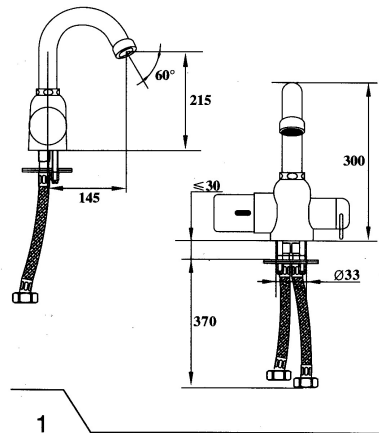

Specification

Product Description	Hands-free faucet	
Material of Casting	Chrome plated brass casting	
Power Supply	DC6v (4 Alkaline "AA" Battery)	
Battery Life	2 years (4,000 uses/month)	
Sensing Range	20-60cm adjust automatically	
Applicable Water Pressure	0.5-8kg/cm ² (8PSI-120PSI)	
Water Inlet Pipe Diameter	G1/2"	
Applicable Room Temperature	1-55°C	
Applicable Water Temperature	1-80°C	
Water Supply Temperature	1-80°C (adjustable)	
Recognition Time	≤ 1s	
Protection Class	IP54	
Multi-Function	Power Lack Alert	Light flashing indicate low battery, and shut off automatically when the battery is weak.
	Cleaning Flush	Flow flushing exceeds 24 hours nonuse.
	Water Saving	Flow stops automatically when the objective is still in the sensor area after 45 second.

How to use

* Water flows automatically when the hands in the sensing area.	1
* Water flow supply is running when the sensor is operating.	2
* Flow stops when the objective leaves the sensing area.	3

Troubleshooting

Appearance	Possible Cause	Problem Solving
Hands moving in sensing area	No water flow, no any sound	Check the power supply. Check the battery installation. Check the battery connection line. Check the water supply and water inlet valve.
	Solenoid Valve connector loosed.	Check the valve connector.
	Something is still in the sensing area.	Remove the resting objective from sensor area and wait for a moment.
	The sensor window is dirty.	Cleaning the sensor window.
	Hands are not in the sensing area or move too quickly to be sensed.	Put the hands in the sensing area.
No water flow, no sound, however the light is on.	Too high water pressure; exceeding working pressure	Decline the water pressure to the working range.
No water flow, hearing the sound of solenoid working.	The water pressure is lower than the working pressure	Enhance the water pressure to the working range
The light flash 0.3s, stop 1s, and then revolving without any water flow.	Weak battery	Replace battery.

[No hands moving] The light is continuously flashing without any water flow.	Something wrong with the programs of control central.	Put the magnet near the controller to stimulate the light flashing; move away the magnet then. After the light stop flashing, waiting for about 90s till to the normal state. If above adjustment can't effective, change the control central.
Normal sensing only with weak water flow.	Low water pressure.	Improve the water supply to working water pressure.
Water flow keeps running.	Filter is obstructed.	Clean the filter. Waiting for about 45s, the controller will adjust automatically; and close the switch automatically.
	Original installation.	

Caution

- * Keep the sensor clean at all times, to avoid dirt or stain deposit that may result in poor sensing effect.
- * Do not attack the sensor.
- * The sensor is electronic instrument. Do not flush the sensor directly.
- * Do not let sunlight or other excess light reflect into the sensor window.
- * Do not have sensor window near strong ultraviolet or electromagnetic field.
- * Keep the sensor window clean.
- The sensor cover can be cleaned by a wet soft cloth with mild liquid detergent; do not use eradicator, abrasive powder or oil, acid or alkali liquid detergent.
- * Faucet is designed for use with potable water. Avoid water that includes a lot of contaminants or acid/alkali water and impure water.

Note:

- * If the water flow decline after installation or used for a long time, the filter may need a wash. Turn off the filter and non-return valve, take out the filter. Clean with a brush and reinstall it.
- * Keep the pipe airtight after reinstallation.
- * If repair is needed, cover the sensor window with black electrician tape. Do not use adhesive tapes; this may cause sensor to be affected by any residue on the sensor window.

Installation

1. Check water supply:

- Prepare the tools and materials such as open end adjustable wrench, tape measure, screw driver, seal tape, etc.
- Remove extraneous matter from the water pipe to avoid obstruction.
- Clean the basin.
- Make sure to turn off water supply before installation.
- Prepare water stop valve in the water outlet on the wall.

2. Connect filter & non-return valve to water stop valve on the wall.

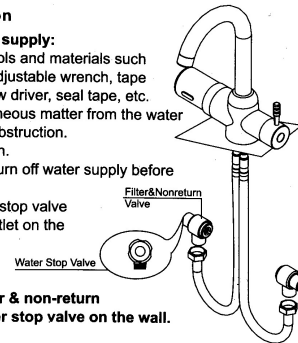

Hands-free Faucet

3. Thread through the hole of the basin, connect the flexible hose to the bottom of the faucet body. Please connect correct position which the red spot is for hot water and blue spot for cold water.

4. Fix the faucet on the basin by locking assembly.

5. Connect the water inlet of the flexible hose to the water outlet of the filter & non-return valve.

★ 6. Test the faucet:

Turn on the water supply and uncover the film on the sensor window.

Test the faucet by moving hands in the sensing area.

If there's no function or flushing, please near the sensor window and move hands for several times till to flushing.

In ordinary, all the test time is not more than 3 minutes.

If there's still no function or flushing, please waiting for about 20 minutes. The faucet will adjust automatically to the normal state.

★ Set up the best appropriate sensing distance
If you want to setup the sensing distance which is within 20-60cm you need, you should act as follow:

- Make the objective still in the right position you need.
- Put the magnet near the sensor window to stimulate indicator to flashing.
- Move away the magnet right now and waiting for the flashing stopped.
- The appropriate sensing distance is set up.

* Replace battery:

- Revolving the ornamental ring and aim the hole to the screw and then unscrew the screw.
- Remove the casting and the cover of the battery box in sequential order.
- Insert the new battery according the direction shown in the battery box; and then close the battery box.
- Replace the battery box, casing in reverse order.
- Tighten the screw with screwdriver.

